



3  1  2 

Radi Estates
9275 2945

Contact Steve Radi
0411755788

Price Offers \$499,000

Type House

Sold Date 21/06/2019

Land 820 m2

6 Coston Place Morley
HOME OPEN CANCELLED - UNDER OFFER Potential PLUS in Comfortable Cul de Sac Location

Positioned ever so peacefully and privately in this tightly held street, take advantage of this much loved home built with generous proportions. Set on 820sqm of almost level land and larger than your average duplex potential block in Morley, the substantial home has the potential to be retained whilst creating a second lot to the rear. Offering great sized bedrooms as well as the original loungeroom, a cosmetic facelift will add amazing value to this solid Morley property. If you are looking to invest into a property that will also double as an easy care family home, then this home will have plenty of room for pets, play and potential future prosperity.

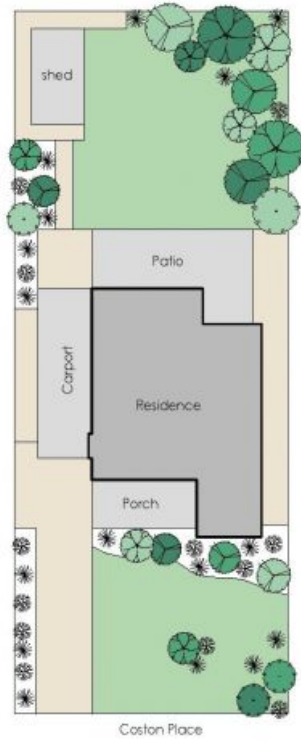

Coston Place

Approximate Areas

Residence:	142m ²
Carport:	38m ²
Patio:	47m ²
Porch:	21m ²
Total area:	248m ²

These plans have been produced for marketing purposes and are approximate only. They are not suitable for other uses.
www.crbcreative.com.au



6 Coston Place Morley